

POSTIE

QUICK START GUIDE



A



B



C



D

A POSTIE Printer Unit × 1

B Thermal Paper Roll (38mm wide x 15m long) × 2

C AC Adapter × 1

D AC Code × 1

Preparation

1 Connect the AC adapter to an AC outlet

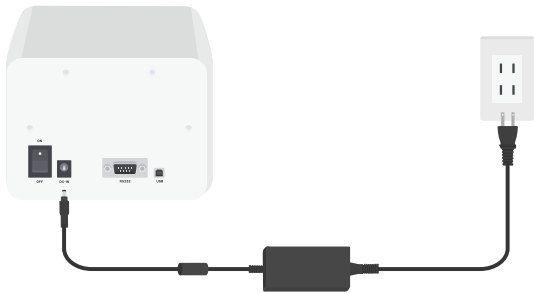

2 Turns on the power switch

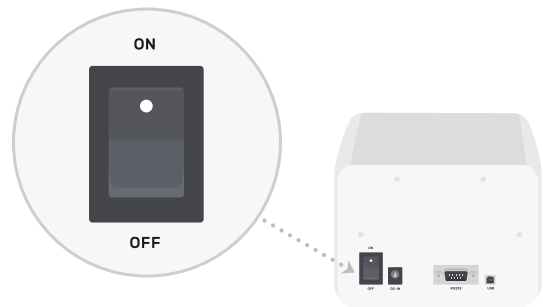

3 Setting paper roll



4 Test printing

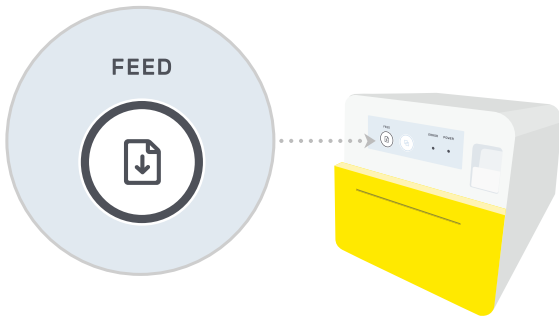

Feed a roll paper

Press and hold the FEED button

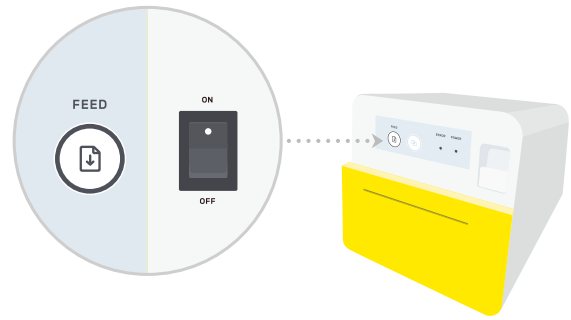

Self test printing

Turn on the power switch by depressing FEED button

Installing the app

1 Download the app



iPhone is here



Supported OS : iOS9 or later



Android is here



2 Launch the app

Launch the app after the installation is completed (cf. [Instruction manual](#)).

You can send your message or print the received message from your friends with the app "POSTIE".

※ When printing your message, you need to pair with the printer and the smartphone on Bluetooth. Tap the Bluetooth button at the top right of the screen and select the printer to connect.

Support

Refer to the website and [instruction manual](#) for support and inquiries.